

HAMMERHEAD DPV



LONG DISTANCE TRAVEL

The Hammerhead DPV (Diver Propulsion Vehicle) is designed to transport a diver at speeds of 4 knots with an 8 hour run time. The lower skid frame offers a robust storage solution for spare bottles and equipment. Aluminum tracks run the length of the hull to mount a variety accessories.



ADJUSTABLE DIVE PLANES

Four individually adjustable dive planes offer unsurpassed diver mobility. Dual controllers allow the DPV to have a zero turn radius, thus maximizing maneuverability in tight spaces. The four thrusters provide a robust towing capacity.

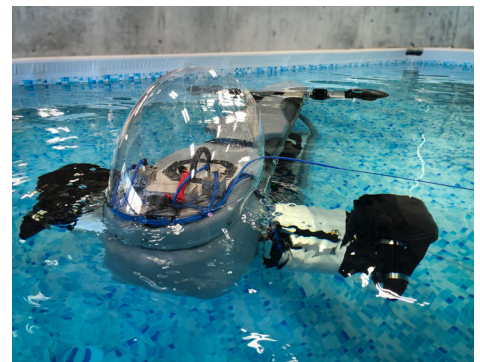

VARIABLE BUOYANCY

Front and rear variable buoyancy tanks allow the DPV to be leveled based on payload placement. At negative 100lbs of buoyancy, the DPV can be left on the sea bed while the operator leaves to perform their mission. An available 200lbs of positive buoyancy can offset the weight of the divers gear and payload.

Phone: (613) 692-6368

Email: mark@edeyfx.com

Address: 3850 Prince of Wales Dr, Ottawa, ON K2C 3H1

EDEY FX



TOP

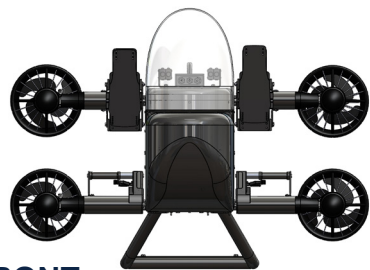
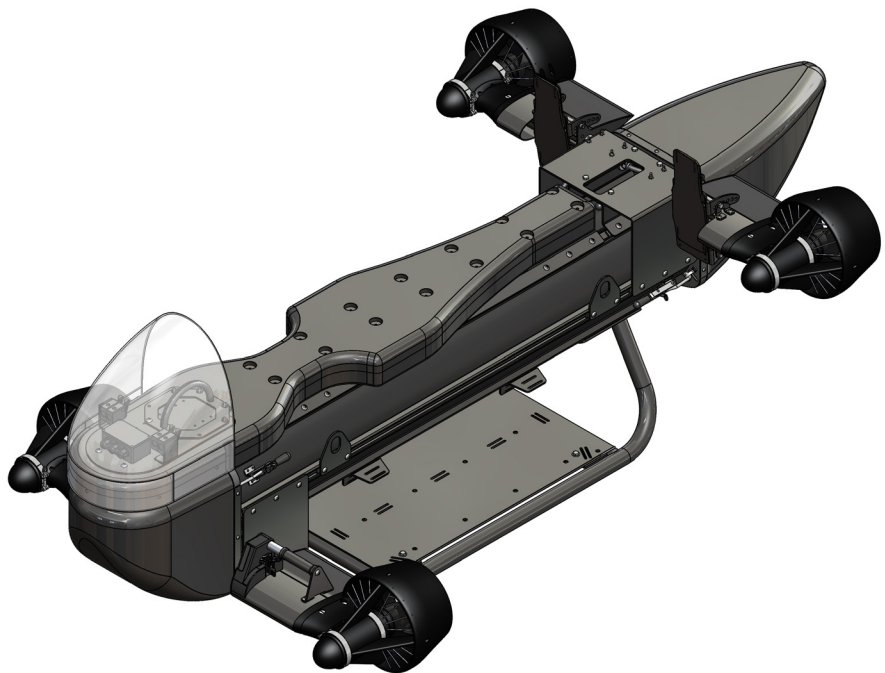

FRONT

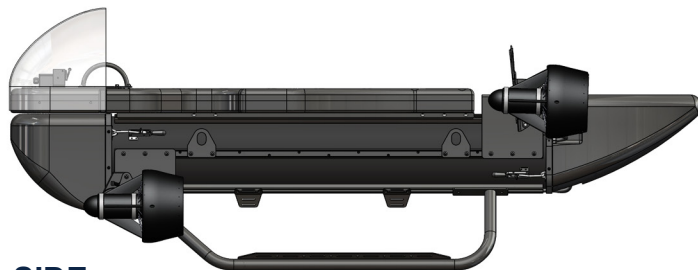

SIDE

SPECIFICATIONS

TOTAL LENGTH, WIDTH, HEIGHT	116" X 60" X 44" (transportable in full sized pick up truck bed)
TOTAL WEIGHT	780lbs (with 19kWh lithium battery)
BUOYANCY	Adjustable from negative 200lbs to positive 100lbs
BATTERY CAPACITY	19 kWh
RANGE	8 hours of run time at full power (approximately 36 miles)
SPEED	4 knots
MAXIMUM DEPTH	120 feet (further testing to greater depths pending)
STEERING	4 Adjustable dive planes, 2 speed controllers (port and starboard)
NAVIGATION	Compatible with modern dive navigation and autonomy systems such as Shark Marine
SAFETY FEATURES	Inflatable emergency buoyancy bags, diver attached master switch, cage protected thrusters.
ADDITIONAL FEATURES	Sling loadable, slide out battery service tray, compressed gas bottle mounts, LED lighting, reconfigurable layouts per mission requirements